

Subject: Genesis Bill Dispenser/Recycler Latch Pin

Overview

There have been occasions in the field where the retaining Lever Pivot Pin for the Bill Dispenser/Recycler can get broken from the Mounting Assembly. Currently when this Pivot Pin breaks the entire Bill Dispenser/Recycler Mounting Assembly must be replaced. This applies to both Right and Left units, though all illustrations below will be of Left only.

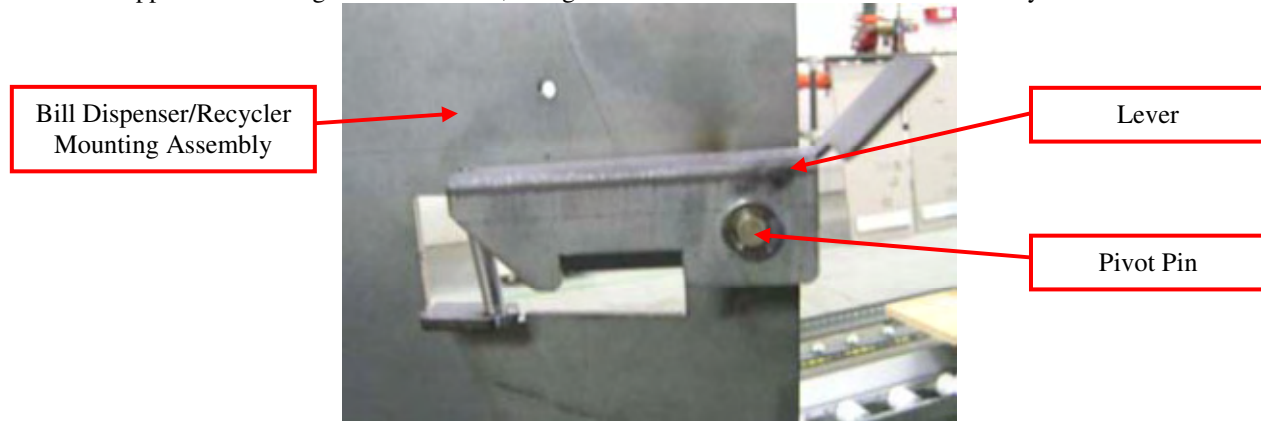

The primary cause of this Pivot Pin breaking is due to a misalignment of the Lever Catch that if the customer slamming BDU/BRU into place causes the Lever to strike the Catch putting excess stress on this Pivot Pin.

Solution

There are multiple actions being taken to: 1) reduce the occurrence of the pin breaking, and 2) allow the field to repair the broken pivot pin without replacement of the entire mounting assembly (when possible).

1. A new Lever has been designed that will reduce the stress on the pivot pin. Anytime this Lever is replaced (whether the Pivot Pin is broken or not), only the new Lever should be ordered. This is Fit On Fail or as needed only.

Description	Part Number	Notes
BDU/BRU Retaining Lever, Left	KD30335-Y216	Obsolete, Use 11004460
BDU/BRU Retaining Lever, Right	KD30348-Y216	Obsolete, Use 11004530
BDU/BRU Retaining Lever, New, Left	11004460	
BDU/BRU Retaining Lever, New, Right	11004530	

2. Verify that the Lever Catch is properly aligned and secured, see instructions below. This is suggested during any service call or site visit.
3. If the Lever Pivot Pin gets broken from the Mounting Base, the repair kits below have been created. These require the following tools: Drill with 15/64" bit, two 3/8" wrenches, Philips Screwdriver. Repair instructions are included with the kits and are also attached to this bulletin for reference.

Description	Part Number	Notes
Genesis BDU/BRU Lever Pivot Repair Kit, Left	11004536F	Includes new Left Lever above
Genesis BDU/BRU Lever Pivot Repair Kit, Right	11004535F	Includes new Right Lever above

There are some cases where this repair kit cannot be used. In those cases the entire mounting assembly must still be replaced. Some examples where the entire Mounting Base would be required are: Mounting Base is also bent, or Pivot

INQUIRIES TO:		DATE
Fujitsu Frontech North America		
Exchange:	Sustaining Engineering	_____
Mail:	Fujitsu USA20, Sustaining Engineering	_____
FAX:	(949) 458-6257	_____
Internet:	SustainingEngineering@us.fujitsu.com	_____
FTP:	ftp://ftp.ftxs.fujitsu.com/Pos/PosSustaining/	_____
Original signature copies maintained by Sustaining Engineering.		

Pin is broken in such a way that it cannot be drilled out (the Pivot Pin is hardened steel). In these cases, the following full assembly will be required.

Description	Part Number	Notes
F53 BDU, Payment Station	11001224S3	
F53 BDU/Bill Bracket Assy, Genesis 3/4, Left	11001224S13	
F53 BDU/Bill Bracket Assy, Genesis 3/4, Right	11001224S12	

Impact

- Production New Lever to be cut into production pending current stock depletion.
- Installed Units New Lever or Lever Pivot repair - Fit on Fail.
 - Upon any service call or site visit, all Lever Catches should be verified for proper alignment and all screws are tight.
- Repair Center None.
- Service Spares
 - Purchase repair kits as needed.
 - When stock of old Levers (above) consumed order only the new Levers.

Bill Dispenser/Recycler Catch Alignment Procedure

1. Remove the 2 screws retaining the Catch and put a drop of Loctite 242 (part number 11002388, or locally purchased) to the screws and loosely reinstall.
2. Push the Catch as **far down and to the rear** of the Genesis as possible and snug the screws.

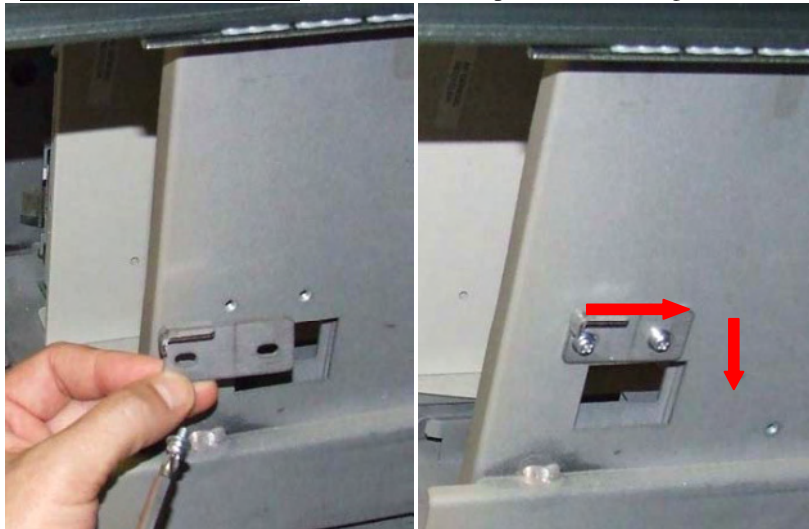

3. The red arrow below indicates the gap that should exist between the Lever and the Catch when the tray is fully racked into the Genesis. This is best verified from the front with your finger, since a visual inspection cannot easily be done.

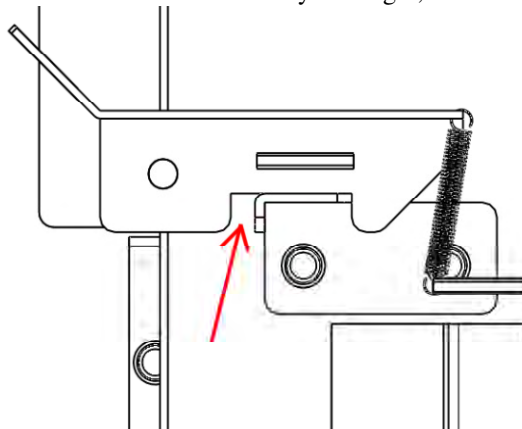

4. Tighten both Catch securing screws. – Done.



BDU-BRU Release Latch Repair Kit

This is document number D900000501, Version 1.2.

Reports have been received from the field that the Bill Dispenser unit (BDU)/Recycler (BRU) release latch can break if the bracket with which it aligns is not adjusted correctly. This manual describes the procedure that must be followed to correct a broken release latch (latch for left hand station casing shown below).

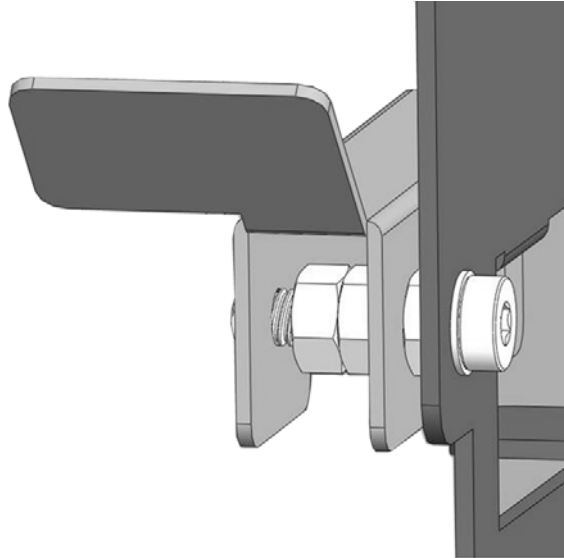

Required Tools:

- drill with 15/64" bit
- two 3/8" wrenches
- screwdriver
- Loctite 242 (part number 11002388, or purchased locally)

Components

The BDU-BRU release latch repair kit is available for left hand and right hand Customer Stations:

Left Hand Station Kit (11004536F) Components	Qty.	Part No.
Release latch lever pin repair kit (see below)	1	11004451
Release latch lever (LH)	1	11004460
Extension spring .188 OD x 1.125 LG, S/S, Fastenal 10430-05307	1	11001778

Right Hand Station Kit (11004535F) Components	Qty.	Part No.
Release latch lever pin repair kit (see below)	1	11004451
Release latch lever (RH)	1	11004530
Extension spring .188 OD x 1.125 LG, S/S, Fastenal 10430-05307	1	11001778

- The pin repair kit (11004451) included in both repair kits above consists of the following components, listed and illustrated below:

Pin Repair Kit Components (11004451)		Qty.	Part No.
A	M6 socket low head cap screw	1	11004452
B	M6 internal tooth-lock washer	1	11004453
C	M6 low head height hex nut	1	11004454
D	M6 hex nut	2	11004454

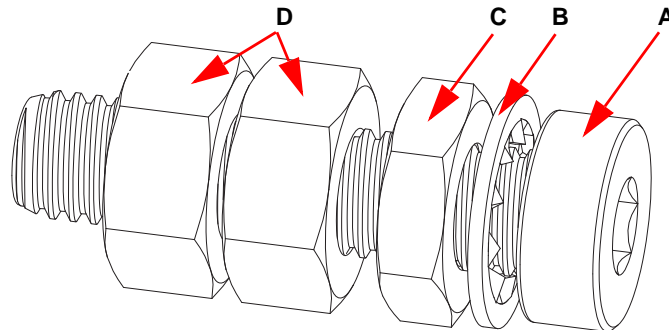

Adjust the Release Latch Bracket Position

Before installing the repair kit, adjust the latch bracket to its proper position on the BDU/BRU tray as shown below.

1. The Bill Dispenser release bracket (11001224) shown below mounts directly above the inside rail with two M4 x 0.7 x 8 screws.



2. Loosen the two screws, then push the bracket all the way to the back and all the way down. Add a drop of Loctite 242 and tighten the screws. This adjustment will eliminate the interference that caused the original pin to break.



3. You will be able to do a final verification of the bracket's position after you re-install the latch. See [Step 11](#).

Install the Repair Kit

1. If the site of the broken pin contains any welding residue, clean out the hole with a power drill using a 15/64" bit. Remove any other remaining welding residue.

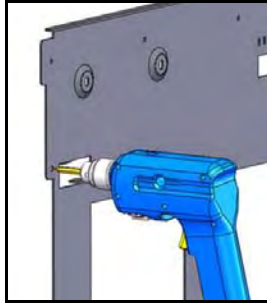

2. Remove the spring that prevents the latch from spinning loosely.

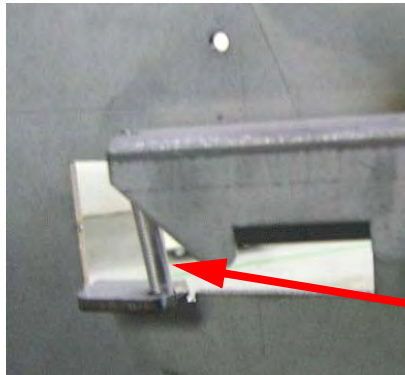

spring

3. Locate the low head cap screw and ensure that it fits into the hole in the tray - if it does not, enlarge the hole with the drill bit until it fits.
4. Install the M6 tooth-lock washer on the cap screw, then insert it into the hole on the BDU/BRU tray.

5. Apply Loctite 242 and then tighten the M6 low head height hex nut on the other side of the tray wall to secure the cap screw in place.

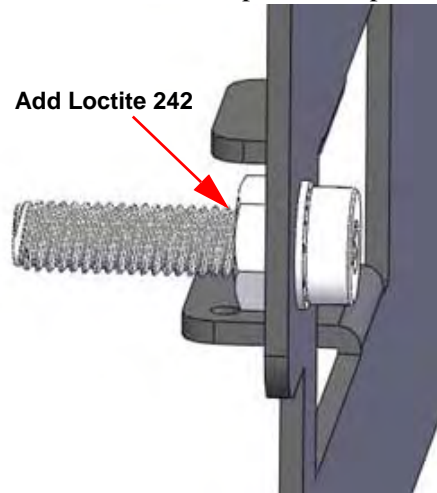

6. Orient the latch as shown below and insert the hole on the right side of the latch onto the cap screw.

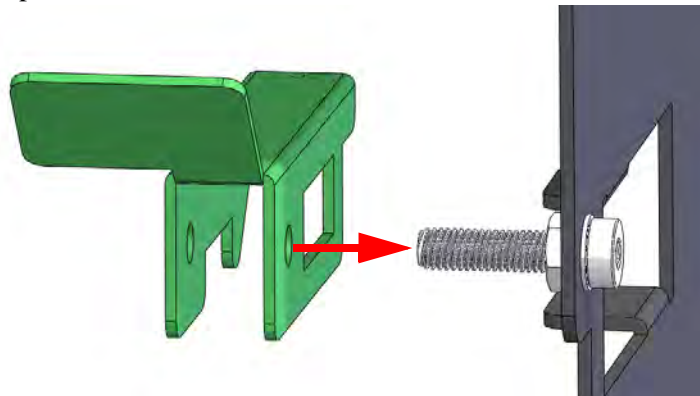

7. Install the two M6 hex nuts together loosely onto the cap screw. Apply Loctite 242 and then finish installing the latch onto the cap screw.

8. Leave a small gap between the latch and the M6 low head height hex nut.

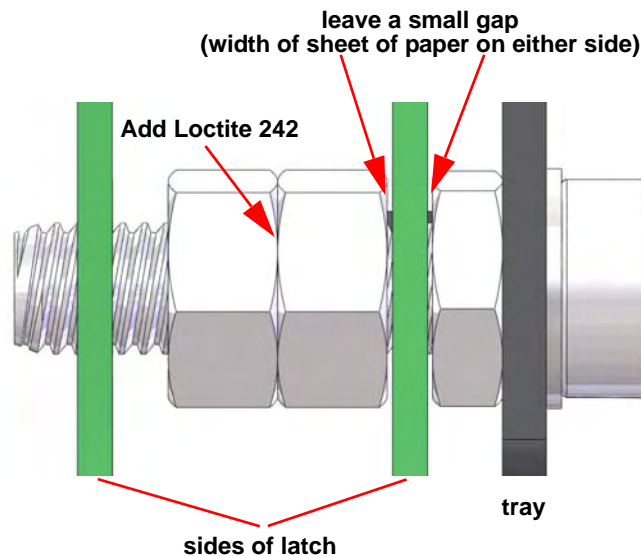

9. Use two 3/8" wrenches to tighten the two M6 hex nuts against one another to secure the latch.

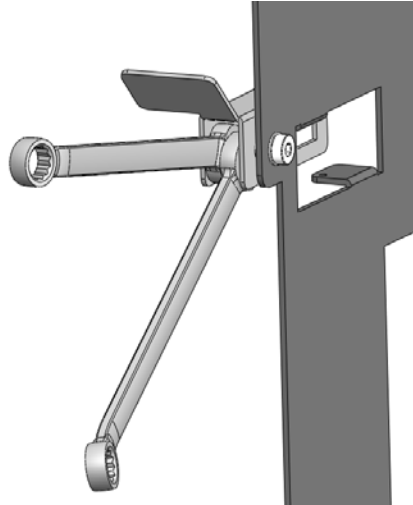

10. Re-install the spring that you removed earlier. It hooks into a small hole at the back of the latch and into a small hole on a flap on the tray directly underneath.
11. The red arrow in the following drawing indicates the gap that should exist when the tray is fully racked into the station. This is best verified from the front with your finger, since a visual inspection cannot easily be done.

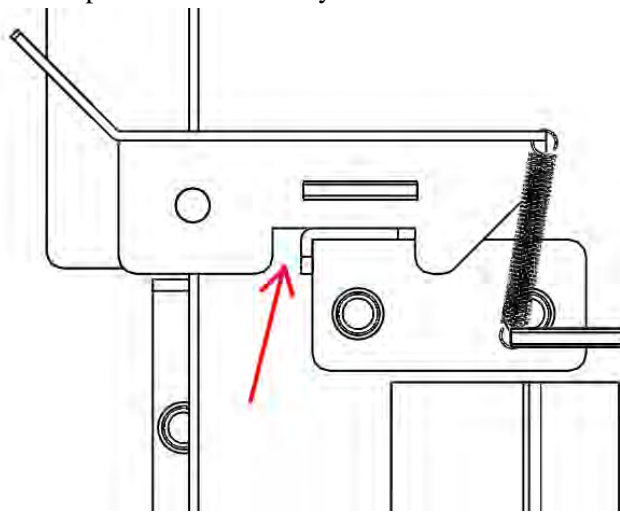

12. Verify the latch a few times by racking the unit into and out of the station.
13. The repair kit installation is complete.